



AGELOC® GALVANIC BODY SPA OWNER'S MANUAL

PLEASE READ AND LOOK OVER THIS DRAFT CAREFULLY. NUMBER AND SEND VIA EMAIL ANY NECESSARY CHANGES.

GBM Creative will not be held responsible for changes not marked and emailed to the group on this draft.

NOTE TO GBM CREATIVE: Make sure to compare date and time stamp on this hard copy with the date and time of the digital file to ensure changes are done to the correct document.

	Initials	Date	<input checked="" type="checkbox"/>		Initials	Date	<input checked="" type="checkbox"/>
Creative Manager		/2012	<input checked="" type="checkbox"/>	Research Scientist		/2012	<input type="checkbox"/>
Designer		/2012	<input type="checkbox"/>	Development Scientist		/2012	<input type="checkbox"/>
Writer		/2012	<input type="checkbox"/>	Legal Trademarks		/2012	<input type="checkbox"/>
Regional Product Manager		/2012	<input type="checkbox"/>	Legal Claims		/2012	<input type="checkbox"/>
Packaging Engineer		/2012	<input type="checkbox"/>	Regulatory		/2012	<input type="checkbox"/>
Marketing		/2012	<input type="checkbox"/>	QA Document Control		/2012	<input type="checkbox"/>

ageLOC® Galvanic Body Spa

Welcome to the luxury and convenience of scientifically advanced spa and anti-aging benefits at home. Now there's no appointment necessary for more contoured, smoother, firmer appearing skin to help your body look younger.

For decades, spa and salon professionals have used gentle galvanic currents in customized treatments to refresh and energize the skin. Today, spa treatments are no longer reserved for the elite—now you can enjoy them as a part of your regular skin and body care regimen, on your schedule in the comfort of your own home.

Ergonomically designed to follow the contours of your body, ageLOC® Galvanic Body Spa features a pulsating galvanic current that helps stimulate and purify, leaving your skin feeling more refreshed than ever before. The ageLOC Galvanic Body Spa also features a self-adjusting galvanic current and proprietary ageLOC body conductive surface designed to increase delivery of ageLOC to your skin when used with ageLOC Body Shaping Gel.

Now you can unlock the secret to more contoured, smoother, firmer looking skin and experience the anti-aging benefits of an at-home spa treatment with the ageLOC Galvanic Body Spa.

Before you begin

Please read the following advisories before using your ageLOC Galvanic Body Spa instrument:

- ⚠ **Caution:** The ageLOC Galvanic Body Spa instrument is only for use on healthy skin. Do not use if you have open sores or wounds, skin inflammation, have allergies to metal, or have problematic or overly sensitive skin. Check with your physician before using if you are pregnant, have a pacemaker or similar device, are epileptic, have a metal implant, or in case of illness.
- ⚠ Always inspect your ageLOC Galvanic Body Spa and conductors before use. Ensure there are no rough or defective surfaces: sharp edges or surfaces. If you notice any abnormalities, do not use and contact your local Nu Skin office.
- ⚠ Ensure that the location where the ageLOC Galvanic Body Spa is stored is maintained at a temperature above 4 degrees Celsius (40° F).
- ⚠ Do not use the ageLOC Galvanic Body Spa on the face or other sensitive areas or for longer than the recommended time. The ageLOC Galvanic Body Spa instrument and products are for external use on targeted areas only. If you experience any prolonged redness or abnormal irritation, discontinue use immediately. If conditions persist, consult your physician. Keep out of reach of children. Use only as directed.

⚠ The ageLOC Galvanic Body Spa instrument is not a body massager. The instrument should gently glide over the skin. There is no need to apply pressure to get maximum benefits. The galvanic currents do the work for you.

⚠ Remove all protective films before beginning.

⊘ This instrument contains batteries. To reduce the risk of shock, burn, fire, or injury, do not immerse your instrument in water. Do not place or store where it may fall or be pulled into a bathtub, shower, sink, or toilet. Never operate the instrument if it has been damaged.

Your ageLOC® Galvanic Body Spa system includes the following:

- 1 Carrying Pouch
- 2 Owner's Manual
- 3 ageLOC Galvanic Body Spa Instrument (with two AAA batteries installed)
- 4 Instrument Stand

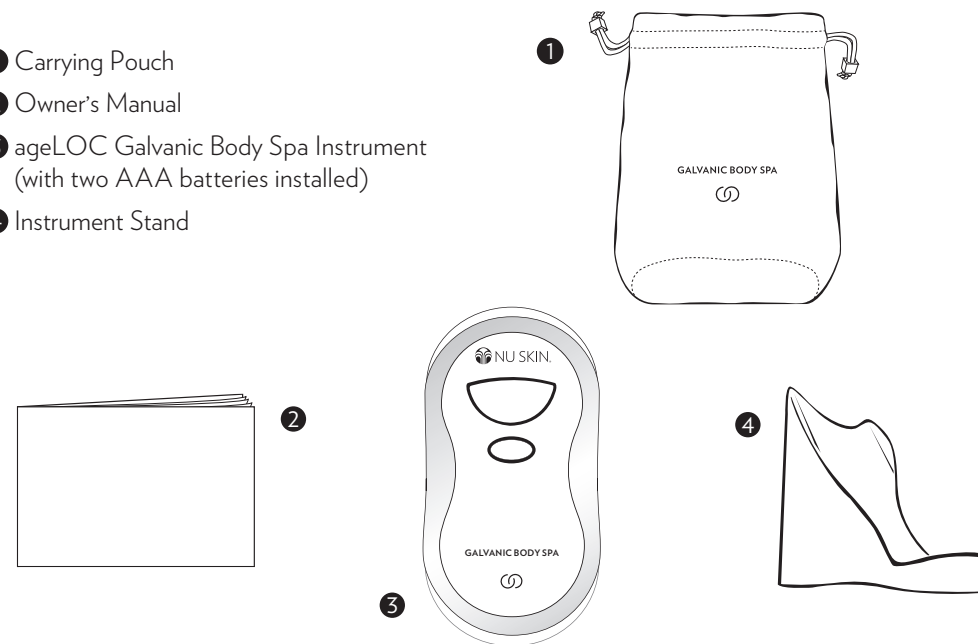

*Treatment products designed for use with the ageLOC® Galvanic Body Spa are sold separately.

Your ageLOC® Galvanic Body Spa Instrument has the following features:

- 1 Display
- 2 On/Off Button
- 3 Chrome Activators
- 4 Battery Compartment (two AAA batteries already installed)
- 5 ageLOC Conductive Surface

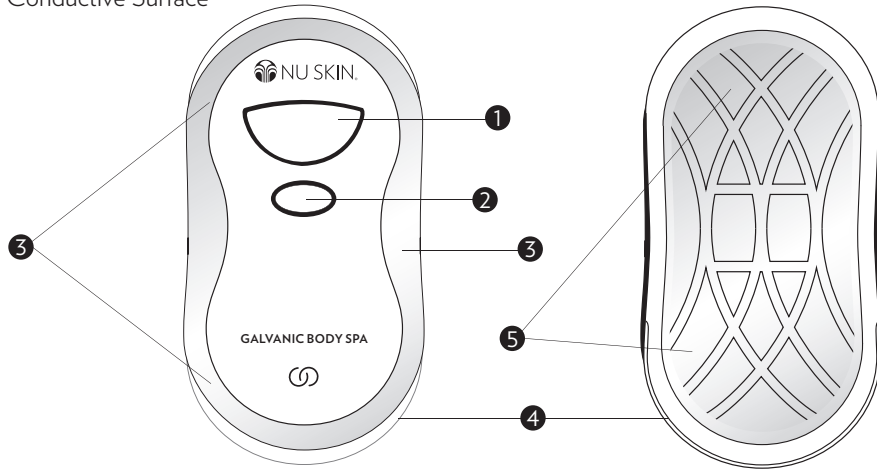

Your display has the following icons:

- 1 Low Battery Indicator—this icon will illuminate when batteries are low.
- 2 ageLOC rings—this icon appears while the instrument is on.
- 3 Clock face and number 5—these icons will appear to indicate the length of treatment time, which is 5 minutes per treatment area.

Note: Remove protective plastic film from instrument before use.

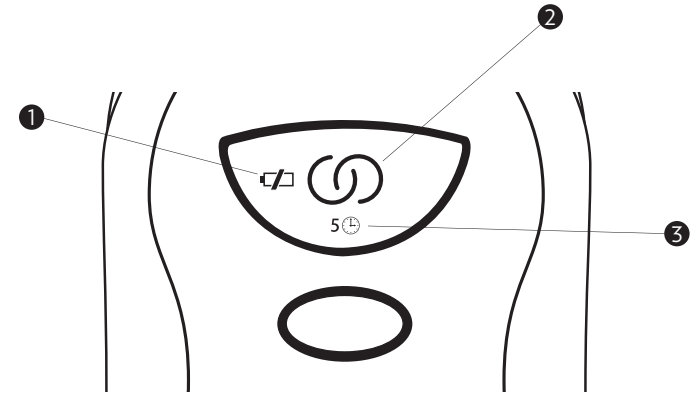

Usage guidelines for your ageLOC® Galvanic Body Spa

Following these general guidelines will assist you in operating your instrument. Please read these instructions before beginning a treatment. Note: **All contact points must be moistened to optimally conduct the galvanic current.**

Handling Your ageLOC Galvanic Body Spa: Firmly hold the device, ensuring contact with the chrome activators (front) while not making contact with the ageLOC conductive surface (back), as seen in the examples shown on the left.

Backlight: The backlight will remain lit while the instrument is on. If the backlight is blinking on and off, it is either because the instrument has lost contact with your skin or there is not enough moisture for optimal conductivity. To continue your spa treatment, ensure adequate moisture at all contact points and resume contact with your skin.



Product application: Apply the treatment gel liberally to the area being treated.

Treatment selection: Press the on/off button once to turn on the instrument, while holding the instrument as indicated above. The ageLOC rings appear in the middle of the display and the treatment time of 5 minutes and clock appears below the ageLOC rings. Thoroughly moisten your fingers and palm with water or NaPCA Moisture Mist. In order for a treatment to begin, gently touch the conductive surface against the treatment area for the current level to self-adjust. The instrument will beep one, two, or three times, indicating that it has self-adjusted to your skin.

To activate the galvanic current: Your moistened hand must be touching the chrome activators while the conductive surface makes contact with the treatment area. Make sure that all contact points are thoroughly moistened. Remember, *all contact points must be wet to optimally conduct the galvanic current.*

During treatment: The instrument will beep every 10 seconds to indicate the unit is on and working. Once treatment time reaches 30 seconds remaining, it will beep every 5 seconds until treatment is complete.

Treatment interruption: To maintain the galvanic current throughout the treatment, you must keep the conductive surface in contact with the area being treated and ensure adequate moisture at all contact points. Lifting the instrument or fingers/hand from the treatment area or chrome activators will disrupt the current and interrupt the treatment. In this case, the backlight will flash on and off and the instrument will stop beeping until the circuit is either reestablished or until the instrument shuts off after two minutes of non-use.

Treatment completion: At the end of your treatment, the clock and number of minutes will disappear, but the ageLOC rings will remain on the screen. A “treatment complete” sound will also play simultaneously. If you wish to initiate another galvanic treatment, press the on/off button and re-initiate the cycle. To turn the instrument off, simply press the on/off button twice.

Optional Rubber Cover: Please refer to this illustration for applying the optional rubber cover to your Body Spa.



ageLOC® Body Shaping Gel

For optimal results, use ageLOC Body Shaping Gel with your ageLOC Galvanic Body Spa once a day, three days a week, on thighs, buttocks, arms, and/or abdomen. Read through these instructions completely before starting your body shaping treatment.



1. Apply ageLOC Body Shaping Gel:

- Smooth gel liberally on area to be treated then rinse hands. If you plan to treat more than one area, only apply gel to the area to be immediately treated.

2. Turn on the ageLOC Galvanic Body Spa:

- Press the on/off button once. The ageLOC rings will appear in the middle of the display. Treatment time displayed with the 5 minute clock will also appear below the ageLOC rings.

3. Perform a treatment with ageLOC Body Shaping Gel:

A. FOR USE ON THE LEGS AND BUTTOCKS

- First, thoroughly moisten your fingers and palm with water or NaPCA Moisture Mist. Hold the instrument with an adequately moistened hand, making sure your fingers are touching the chrome activators. Ensure that your fingers do not touch the conductive surface on the underside of the instrument, as this will not allow the instrument to self-adjust to the skin on the targeted area. Touch the conductive surface to your skin where you have applied ageLOC Body Shaping

ageLOC® Body Shaping Gel (continued)

Gel. You will hear one, two, or three beeps as the instrument automatically adjusts the current level for your skin. Begin lightly massaging in a circular motion where the product has been applied, moving up the thigh and gliding back down.

B. FOR USE ON THE ARM

- First, thoroughly moisten your fingers and palm with water or NaPCA Moisture Mist. Hold the instrument with an adequately moistened hand, making sure your fingers are touching the chrome activators. Ensure that your fingers do not touch the conductive surface on the underside of the instrument, as this will not allow the instrument to self-adjust to the skin on the targeted area. Touch the conductive surface to your skin where you have applied ageLOC Body Shaping Gel. You will hear one, two, or three beeps as the instrument automatically adjusts the current level for your skin. Begin lightly massaging in a circular motion where the product has been applied, moving up the arm and gliding back down.

C. FOR USE ON THE ABDOMEN

- First, thoroughly moisten your fingers and palm with water or NaPCA Moisture Mist. Hold the instrument with an adequately moistened hand, making sure your fingers are touching the chrome activators. Ensure that your fingers do not touch the conductive surface on the underside of the

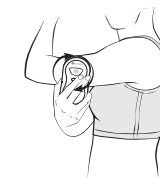

ageLOC® Body Shaping Gel (continued)

instrument, as this will not allow the instrument to self-adjust to the skin on the targeted area. Touch the conductive surface to your skin where you have applied ageLOC Body Shaping Gel. You will hear one, two, or three beeps as the instrument automatically adjusts the current level for your skin. Begin lightly massaging in a circular motion where the product has been applied, moving across the abdomen.

4. **If you lose contact with the chrome activators** at any time during your treatment, simply adjust your hold on the instrument and resume your treatment. The instrument will beep every 10 seconds to indicate that it is on and working properly. Once treatment time reaches 30 seconds remaining, it will beep every 5 seconds until treatment is complete.
 - a. At the end of your treatment, the instrument will emit a long beep followed by two short beeps, indicating that treatment is complete. The clock and treatment time will disappear, and the ageLOC rings will be visible for 30 seconds of inactivity. Remove excess product from your skin. Clean remaining product from the instrument and conductive surface with a damp towel and dry thoroughly.
 - b. To begin another galvanic treatment, press the on/off button and re-initiate the cycle. Follow the directions above for the area you wish to treat.

ageLOC® Body Shaping Gel (continued)

5. **For an extension of benefits**, use ageLOC Dermatic Effects* each day, morning and night. Read your ageLOC Dermatic Effects directions completely before using.

Note: 5 minutes is the recommended treatment time for one area, but you may not need the full 5 minutes.

*ageLOC Dermatic Effects is not suitable for use with galvanic currents and should not be used with your ageLOC Galvanic Body Spa.

Important Maintenance and Warranty Information

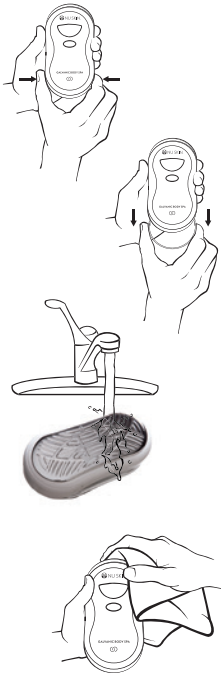

Directions for cleaning your instrument: After treatment, rinse under running water or use a damp cloth to remove any excess product from the instrument. Dry thoroughly. Store in a dry place.

Note: We recommend you thoroughly clean your ageLOC Galvanic Body Spa once a month. Remove the spa door by applying pressure on the door sides and pulling outward. Leave the watertight battery plug in place and then rinse the instrument under warm water, wipe with a cloth, and leave to dry. Only put the spa door securely back into place once the spa is completely dry.

Limited two-year warranty: Nu Skin guarantees the ageLOC Galvanic Body Spa to be free from defects in materials and workmanship for a period of two years from the original date of consumer purchase. This warranty does not cover damage to the product as a result of misuse or accident. If the product becomes defective within the two-year warranty period, please call your local Nu Skin office to arrange for a replacement.

Important Maintenance and Warranty Information (cont.)

Directions for Changing Batteries: Your ageLOC Galvanic Body Spa comes installed with two AAA batteries. When the batteries are low, the Low Battery indicator will appear on the display screen. When this happens, install two new AAA batteries.

To replace batteries, apply pressure just above the battery compartment cover. Grip the cover tightly and pull firmly. If the cover is difficult to remove, apply more pressure to the instrument and pull on the cover with greater force, applying that force alternatively on one side of the cover and then the other. The cover will eventually disengage from the compartment. Then remove the rubber plug over the batteries.

Pull gently on the ribbon to remove the used batteries. Replace with two fresh AAA batteries by following the placement instructions in the battery compartment. Remember to tuck the ribbon under the batteries to facilitate future removal. Failure to tuck the ribbon may result in disruption of the rubber seal inside the cover, which may allow water to leak into the compartment resulting in damage to the instrument.

Put the battery rubber cover back on and then slide the door securely into place.

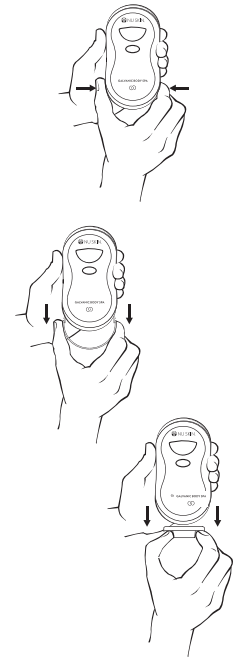



NU SKIN®
THE DIFFERENCE. DEMONSTRATED.®



© 2011, 12 NSE PRODUCTS, INC.
75 WEST CENTER STREET
PROVO, UT 84601
WWW.NUSKIN.COM

1-800-487-1000

XXXXXXXXXX